

GENERAL CATALOGUE

MOVEMENT MOVEMENT

Special Cylinder

Adjustable Stroke Cylinder

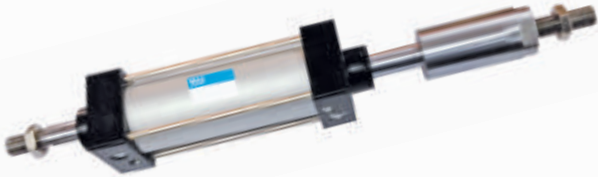

Order Code

ESC

Series

SDNC: SDNC series double acting cylinder
SDNU: SDNU Series double acting cylinder
ESC: ESC series double acting cylinder
ESU: ESU series double acting cylinder
EMAL: EMAL series double acting cylinder
SDA: SDA series double acting cylinder
SDVU: SDVU series double acting cylinder

50 x100

Size
Bore X Stroke

S

Magnet
Blank: without magnet
S: with magnet

50J

Adjustable stroke length



Adjusted Stroke

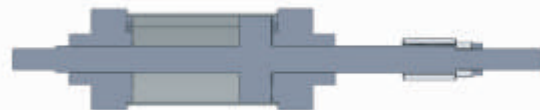

Complete Stroke

Twin Rod



Twin Rod Cylinder

The twin rod cylinders are suitable for applications that require the non rotation of the piston and resistance of flexion. This is done by mounting the cylinder with the rod parallel to the radial load action.

Technical Parameter

Bore (mm)	32 ~ 100
Action	Double acting type
Applicable medium	Filtered Air
Pressure range	0.1 ~ 0.9 MPa
Proof pressure	1.35 MPa
Temperature range	-5 ~ 70°C
Speed range	300 ~ 800 mm/s
Cushion type	Adjustable Buffer